HEDMAN®

The HEDMAN Company • 189 Gordon St. • Elk Grove Village, IL 60007 • 800-872-2788

NOTICE

Proprietary Information - this material is not to be reproduced by any means or disclosed in any way without prior written approval by THE HEDMAN COMPANY.

Disclaimer - this material is subject to change without notice and should not be construed as a commitment by THE HEDMAN COMPANY. Neither express nor implied warranty is made regarding the procedures herein, their merchantability, or fitness for any specific application.

These procedures are provided solely on an "as-is" basis, and the customer agrees to assume any costs arising from use or misuse of the material, including all correction and damages consequential or incidental.

THE **HEDMAN** COMPANY - ALL RIGHTS RESERVED.

© 2001 The Hedman Company



HF100 FOLDER

OPERATING & SERVICE MANUAL

THE **HEDMAN** COMPANY

189 Gordon St.

Elk Grove Village, IL 60007

800-872-2788

Printed in U.S.A.
Form No. 198557HF

Form No. 198557HF

TABLE OF CONTENTS

Page	
4	SPECIFICATIONS
5	COMPONENTS & CONTROLS
6	AUTOMATIC FOLDING
7	MANUAL FOLDING
8-10	MAINTENANCE
8	Removing Cartridge
9	Cleaning Feed Roller
10	Adjusting Separator
11-12	SERVICE
11	Replacing Separator
12	Replacing Feed Roller
13-19	PARTS DRAWINGS & PARTS LISTS
13	Fold Plates
14-15	Drive Assemblies
16-17	Covers & Knobs
18	Feed Tray
19	TROUBLESHOOTING

TROUBLESHOOTING

1. FOLD QUALITY

- A. Documents skew - crooked folds
 - 1. As folder runs, adjust PAPER GUIDES slightly to correct the skew.
 - 2. Re-position paper in HOPPER. Hold HOPPER LEVER open and load paper squarely and centered. Slowly release HOPPER LEVER.
 - 3. Too much paper in folder. Stop folding and remove some paper. Maximum paper stack is 5/8" (16 mm).
 - 4. Remove and clean CARTRIDGE.
WARNING: Turn POWER SWITCH off and unplug POWER CORD before removing CARTRIDGE.
 - 5. Clean FEED ROLLER.
- B. Fold dimensions are incorrect
Remove CARTRIDGE.
WARNING: Turn POWER SWITCH off and unplug POWER CORD before removing CARTRIDGE.
NOTE: Use compressed air to blow obstructions out of FOLD PLATES.

2. CLEARING PAPER JAMS

- A. Remove CARTRIDGE and clean (refer to instructions on page 8).
- B. Clean FOLD PLATES using compressed air.

3. DOUBLE FEEDING

- A. Clean FEED ROLLER using alcohol.
- B. Adjust SEPARATOR (refer to instructions on page 10).
- C. Replace FEED ROLLER and SEPARATOR (refer to instructions on pages 11 and 12).

4. NOT FEEDING - IRREGULAR FEED

- A. Change paper if possible. Some types of paper do not feed well.
- B. Clean FEED ROLLER using alcohol.
- C. Replace SEPARATOR and check FEED ROLLER (refer to instructions on page 11).
- D. MOTORS run, FEED ROLLER does not drive, but rotates freely.
 - 1. Replace "O" RING, page 15, #19.

FEED TRAY

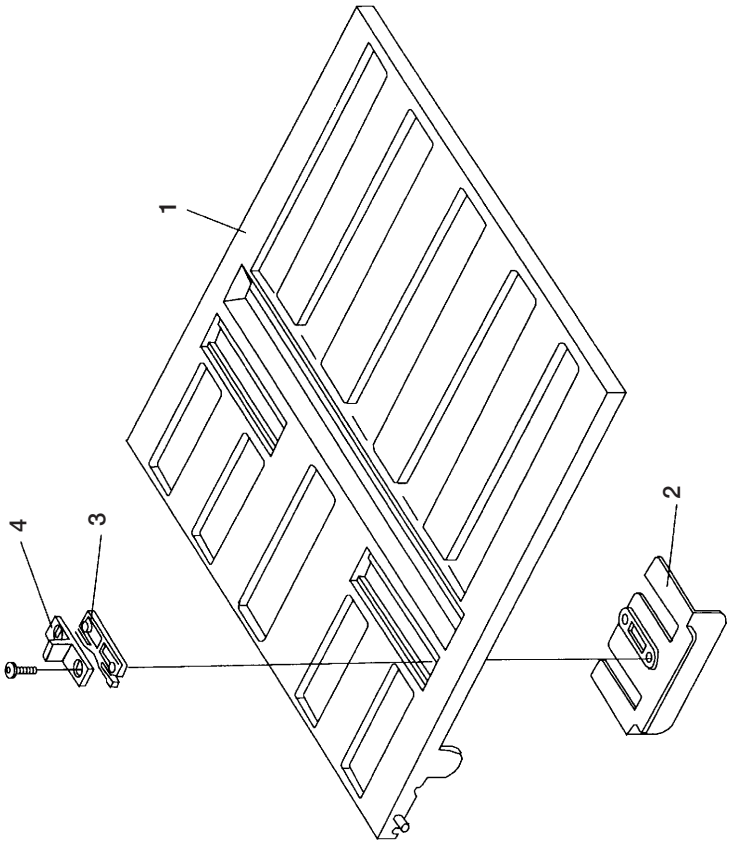

ITEM #
1
1
2
3
4

PART #
6F1582
6F 1582IN
3F1544
3F1522
3F1521

DESCRIPTION
COVER, TOP SCREENED
COVER, TOP SCREENED (FOR A-4 PAPER)
PAPER GUIDE
GUIDE SPRING
GUIDE RETAINER

DECLARATION OF CONFORMITY

(Manufacturer's Declaration according to EC Machinery Directive
89/392/EEC, Annex II A)

Applicant: The Hedman Company
189 Gordon St.
Elk Grove Village, IL 60007

Manufacturer: AUTOMECHA Mfg.
Route 12
Oxford, NY 13815

The manufacturer declares that the following described machine complies with the appropriate basic safety and health requirements of the EC Machinery Directive 89/392/EEC, based on its design and type. In case of alteration of the machine, not agreed to by the manufacturer, this declaration will lose its validity.

Equipment Type: Paper Folding Machine

Model Designation: HF100-IN, HF100-UK.

Description: Rated Voltage - 15 VDC (Output of stand-alone power supply)
Rated Input Power - 1.4A

Applicable EC Directives: EC Machinery Directive (89/392/EEC)
EC Low Voltage Directive (72/23/EEC)
EC Electromagnetic Compatibility (89/336/EEC)

Applicable Standards: EN 292, EN294, EN 60950, EN 55014
(C.I.S.P.R. 14). EN 50082-1. IEC 801

Date/Authorized Signature: 
20 April, 2001

Title of Signatory: Agent

SPECIFICATIONS

POWER: 15V, D.C.(14.8)/1.4 amp/external; wall mountable;
power pack with internal circuit breaker
UL, CSA & FCC approved
120/220/240 V.A.C., 50/60 HZ
International approvals TUV, GS, CE

WEIGHT: 20 lbs. (9.0 kg) / 26 lbs. shipping (11.8 kg)

SPEED: up to 200 sheets per minute

PAPER SIZE: 8.5" x 11" (or A4 European)

PAPER WEIGHT: 16 to 24 lb. bond/up to 60 lb. offset (50 to 180 GSM)

HOPPER CAPACITY: up to 150 sheets

MANUAL FEED CAPACITY: 3 sheets stapled or loose

FOOTPRINT: 12" (30.4 cm) long x
13" (33 cm) wide x
8.75" (22.2 cm) high

COVERS & KNOBS

ITEM #	PART #	DESCRIPTION
1	3F1618	INDICATOR, DIAL
2	6F1549-02	COVER ASSEMBLY
3	3F1609	LEVER
4	7F1596	SEPARATOR SHAFT ASSEMBLY
5	3P1911	RUBBER FOOT
6	3F1553	POWER SUPPLY (120V)
6	3F1643	EUROPE POWER SUPPLY (220V)
6	3F1642	UNITED KINGDOM POWER SUPPLY (220V)
7	3F1549-01	COVER, NON-OPERATOR SIDE
8	7F1656	ON/OFF/JOG SWITCH AND HARNESS
9	7F1571	POWER JACK ASSEMBLY - NOT SHOWN
10	3F1657	LABEL, SWITCH - NOT SHOWN
11	3F1619	SHIPPING CARTON, MACHINE - NOT SHOWN
12	3F1607	CORK PATCH
13	3F1592	SPRING WINDER (Not shown - only on machines with Serial # 300D1471 and lower)
14	3F1591	SPRING (Not shown - only on machines with Serial # 300D1471 and lower)
15	3F1653	SPRING, FEED DOOR (Only on machines with Serial # 300D1471 and higher)
16	3F1541	BASE
17	3F1599	PAPER DEFLECTOR
18	3F1586	FEED DOOR
19	3F1539	FRONT BAFFLE
20	6F1545	LARGE END
21	3F1546	INNER COVER
22	3F1585	PAPER END STOP
23	3F1506	PAPER DEFLECTOR EXTRUSION

COVERS & KNOBS

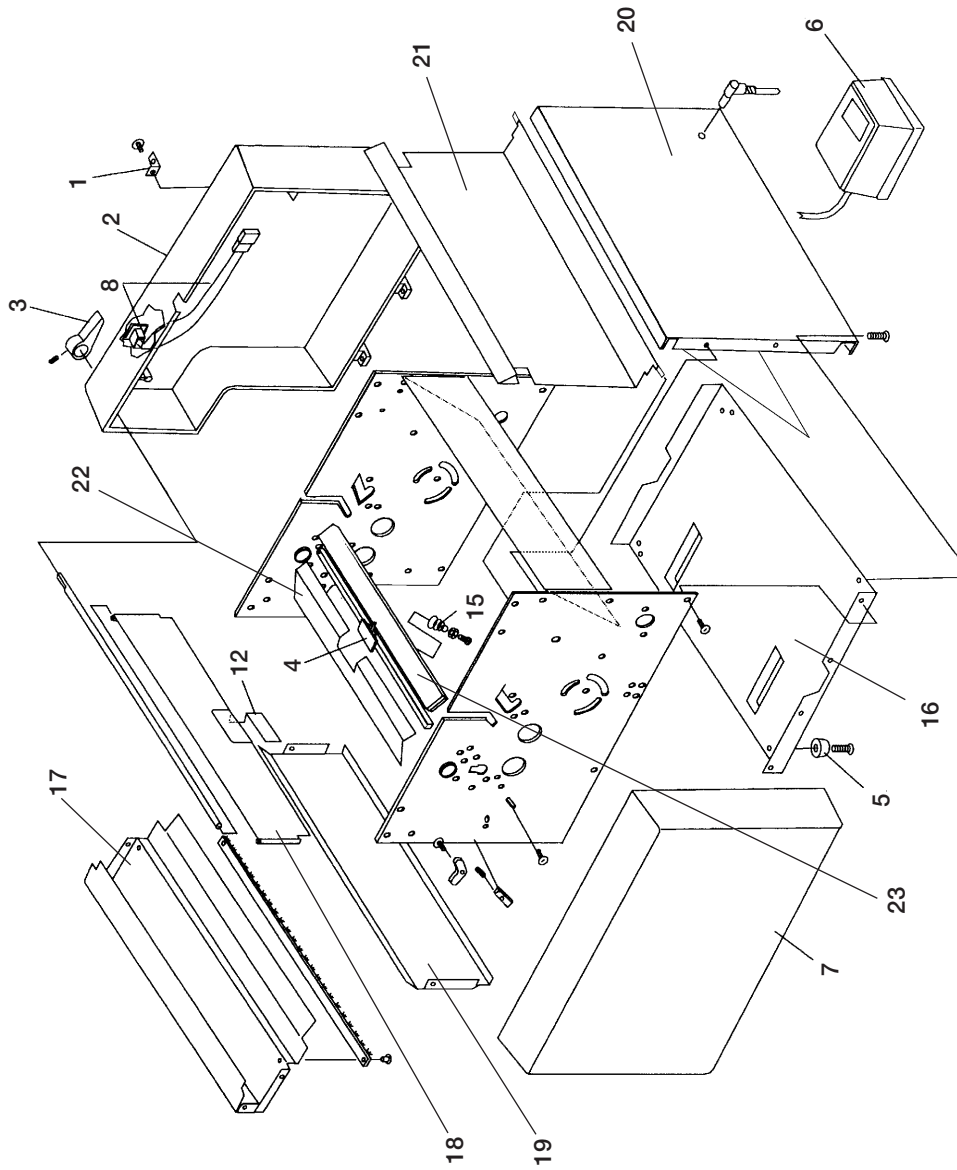

COMPONENTS & CONTROLS

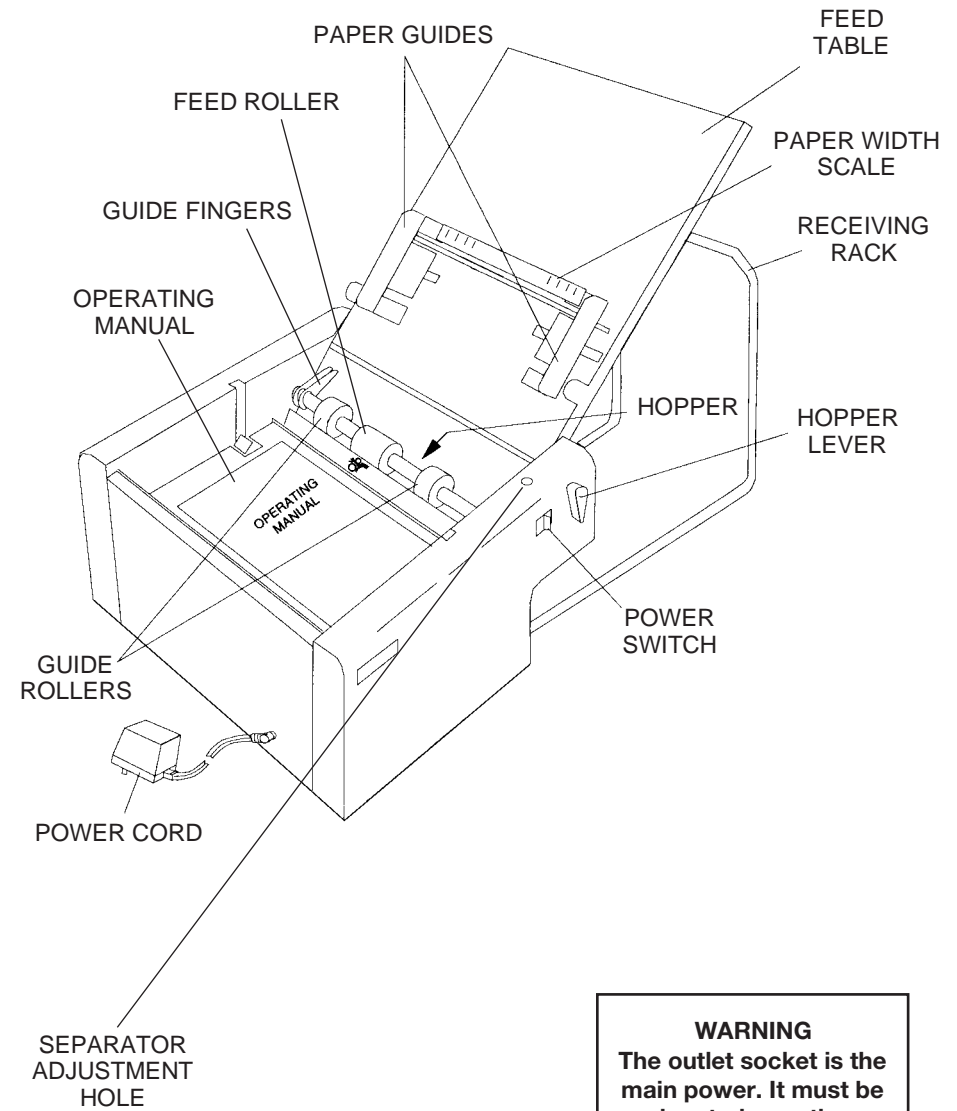

WARNING
 The outlet socket is the main power. It must be located near the equipment and easily accessible.

AUTOMATIC FOLDING

(Stack of sheets up to 5/8" (16 mm) high)

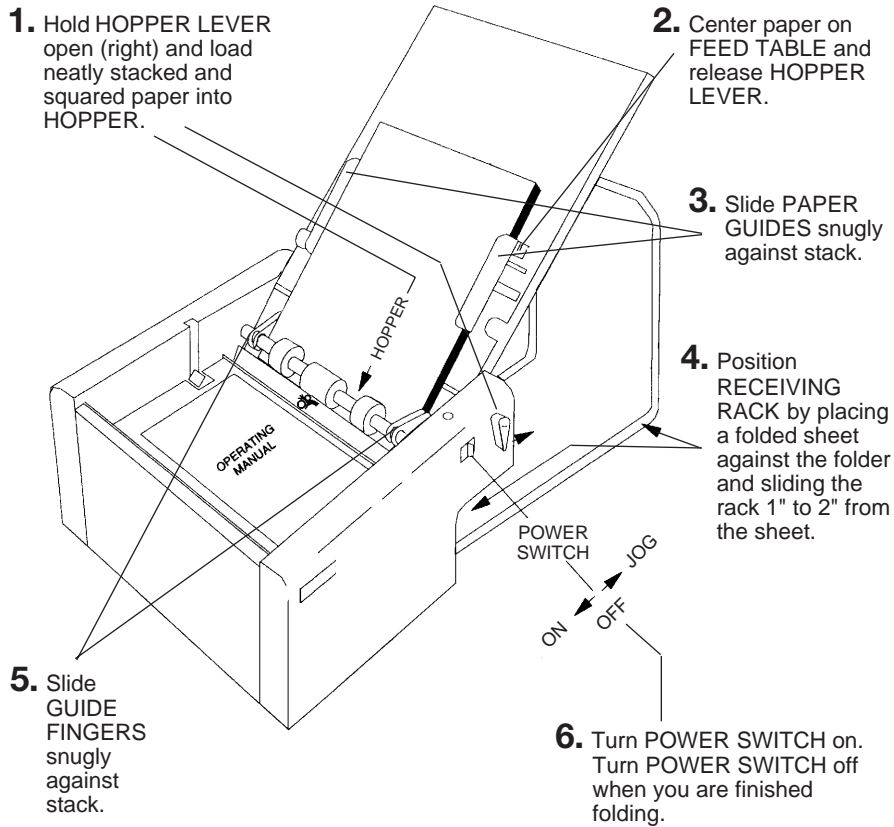

DRIVE ASSEMBLIES

ITEM #	PART #	DESCRIPTION
1	3F1559	GEAR (24T 20PA 24P)
2	7F1525	FEED ROLL ASSEMBLY
3	3F1536	PULLEY, FEED ROLL
4	3F1601	GUIDE, FRONT
5	3F1581	SPRING, CLUTCH
6	3F1602	BUSHING, SPLIT
7	3F1608	ROLLER, GUIDE
8	3F1525	ROLLER, FEED
9	7F1519	GEAR ASSEMBLY
10	3P1916	MICRO SWITCH
11	3F1556	MOTOR
12	3F1511-02	PRESSURE LEVER (OPERATOR SIDE)
13	3F1511-01	PRESSURE LEVER (NON-OPERATOR SIDE)
14	3F1514-01	SPRING, PRESSURE LEVER (NON-OPERATOR SIDE)
15	3F1514-02	SPRING, PRESSURE LEVER (OPERATOR SIDE)
16	7F1551	CARTRIDGE ASSEMBLY
17	3F1594	HOLDER, SQUARE SHAFT
18	3F1510	BEARING RETAINER SHORT
19	3F1637	"O" RING
20	3F1603	PULLEY, SMALL FEED
21	3F1557	BELT, 1/5 PITCH (134XL037)
22	3F1555	PULLEY, DRIVE 26T
23	7F1526	2 STEP PULLEY ASSEMBLY
24	3F1558	BELT, 1/5 PITCH (148XL037)
25	3F1554	PULLEY, MOTOR 10T
26	3F1552	BEARING
27	3F1543	RECEIVING RACK
28	05-0795-00	CAM SWITCH
29	02-1598-02	RUBBER "O" RINGS

DRIVE ASSEMBLIES

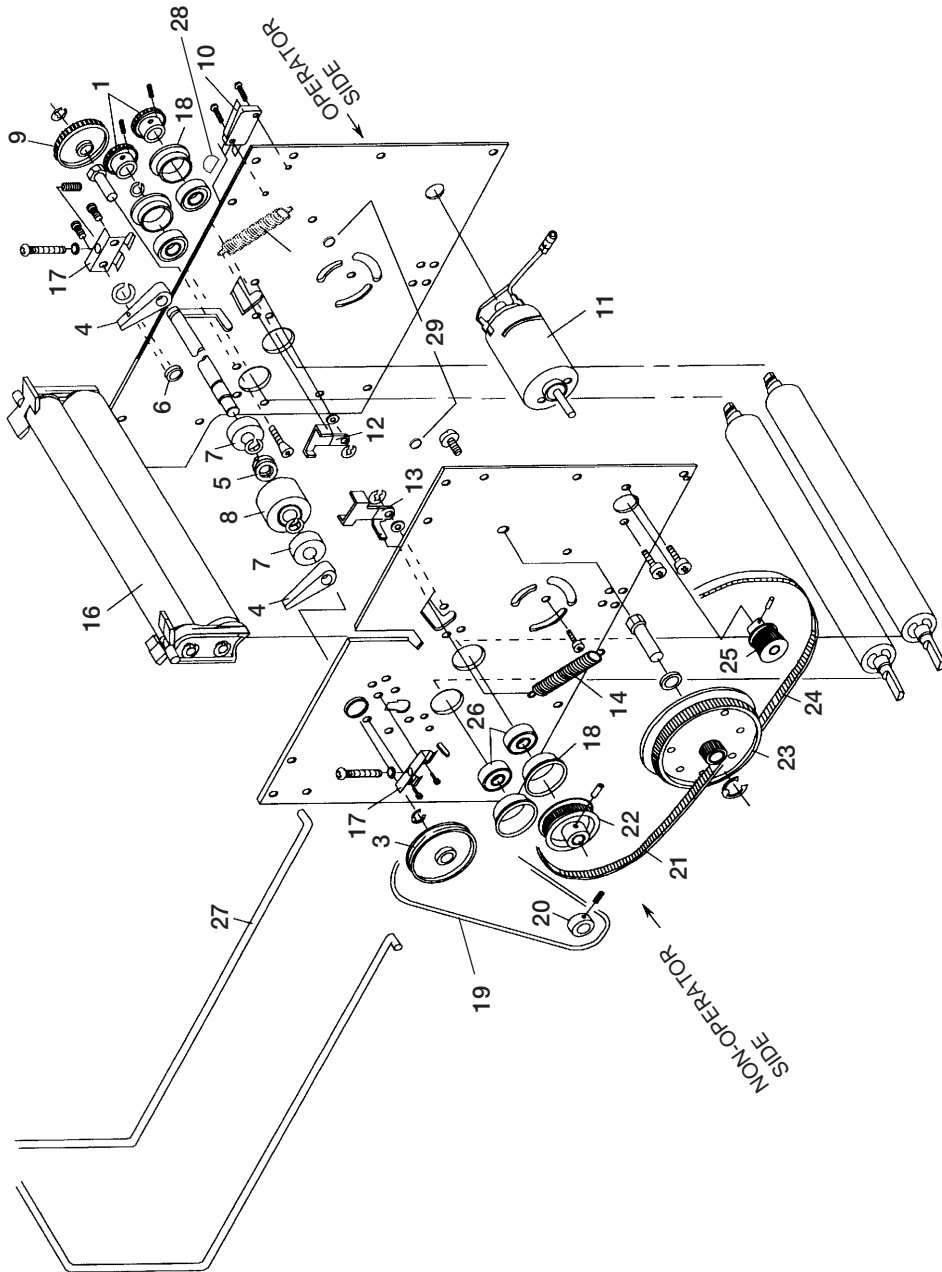

MANUAL FOLDING

(1 to 3 sheets stapled or loose)

1. Close FEED TABLE onto top of folder.

2. Slide PAPER GUIDES as far apart as possible.

3. Insert sheet(s) squarely into SLOT and let them rest on your finger as shown. **Do not hold sheet(s).**

4. Turn POWER SWITCH to JOG until paper is folded.

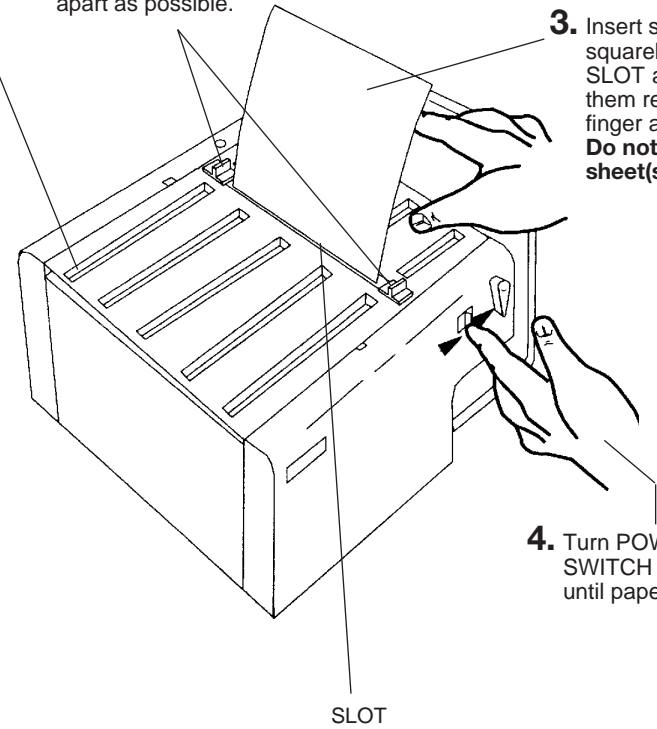

MAINTENANCE

Removing CARTRIDGE

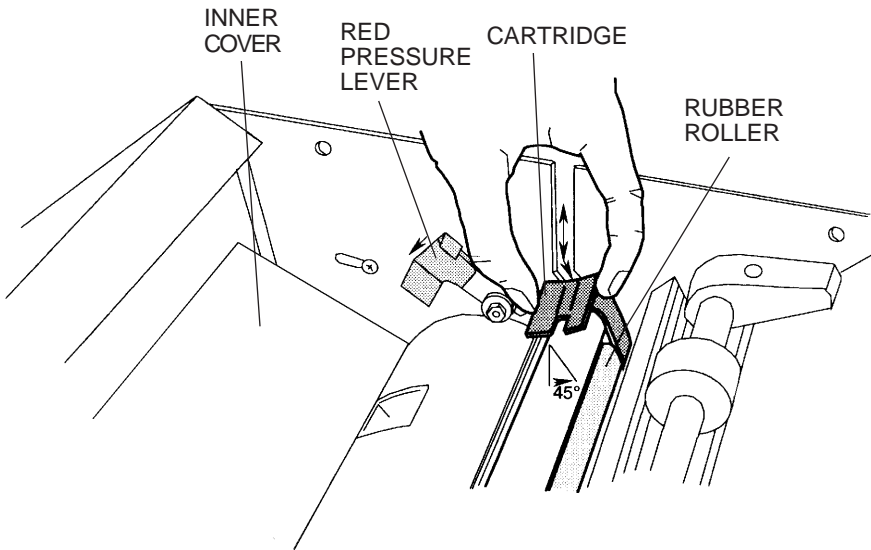

WARNING: Turn POWER SWITCH off and unplug POWER CORD before removing CARTRIDGE.

To Remove CARTRIDGE:

1. Open TOP and INNER COVERS.
2. Pull back RED PRESSURE LEVERS.
3. Remove CARTRIDGE by sliding it up and out of the folder in the slot. When installing CARTRIDGE, the RUBBER ROLLER must be held at a 45° angle toward the feed end of folder (refer to illustration above).
4. Once in place, push the CARTRIDGE down to make sure it is in place and leveled.
5. Close RED PRESSURE LEVERS.
6. Close TOP and INNER COVERS. Important: INNER COVER must be closed or folder will not run.

NOTE: If CARTRIDGE has wear marks, cuts, etc., it must be replaced. (Part # 7F1551).

FOLD PLATES

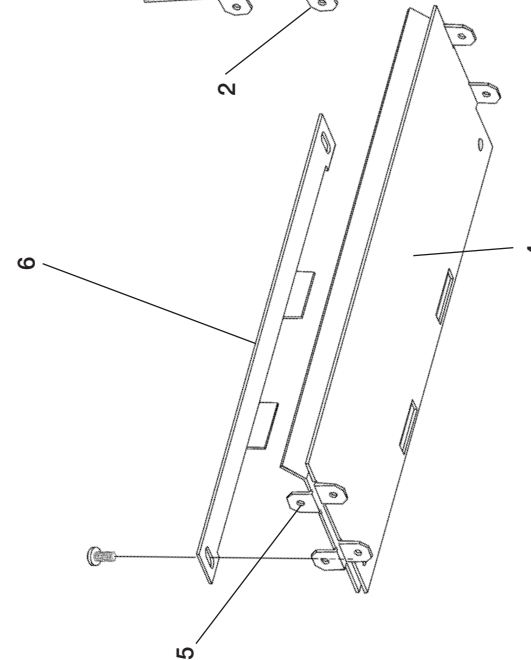
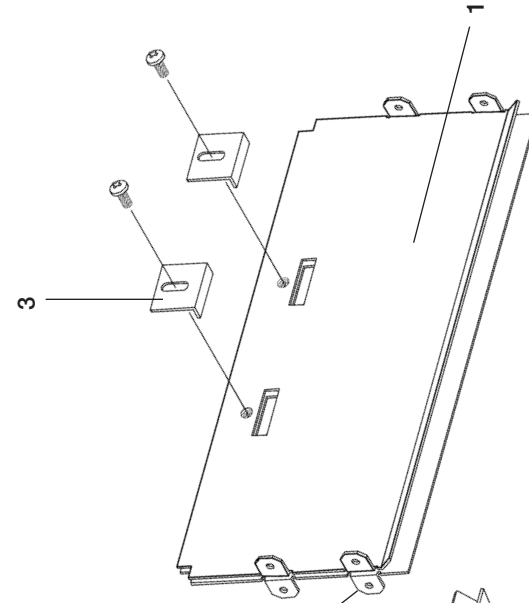

DESCRIPTION
"A" OUTER FOLD PLATE
"A" INNER FOLD PLATE
"A" STOP
"B" OUTER FOLD PLATE
"B" INNER FOLD PLATE
"B" STOP

PART #
04-0364-00
04-0365-00
04-0313-00
04-0427-00
04-0426-00
04-0314-00

ITEM #
1
2
3
4
5
6

Replacing FEED ROLLER

If the FEED ROLLER is visibly worn or is chunking apart, it must be replaced. When changing the SEPARATOR, replace the FEED ROLLER as well.

To change the FEED ROLLER:

1. Turn POWER SWITCH off and unplug POWER CORD.
2. Remove SIDE COVERS.
3. Remove DRIVE BELT and PULLEY.
4. Remove the "E" RINGS on the inside of frames next to the OILITE BUSHINGS.
NOTE: OILITE BUSHINGS are pressed in and removal is not necessary.
5. Loosen GUIDE ROLLERS and slide the shaft 3 to 4 inches to the operator side so GUIDE FINGER, BUSHING and GUIDE ROLLER can be removed.
6. Remove the "E" RING located next to the FEED ROLLER. Slide the FEED ROLLER off as well as the CLUTCH SPRING. Inspect inside of CLUTCH SPRING for wear. If a "flat" wear area has appeared instead of normal rounded coils, replace the CLUTCH SPRING (part# 3F1581).
7. Clean the shaft and lightly lubricate with a light machine oil, the area on the shaft where the CLUTCH and FEED ROLLER are mounted. Reassemble the FEED SHAFT.
8. The FEED ROLLER should spin easily in one direction and "lock-up" when spun in the opposite direction. **NOTE:** If the roller does not "lock-up", there is too much lubrication between CLUTCH SPRING and FEED SHAFT.
9. Re-assemble shaft into frame.
10. Lightly oil the OILITE BEARINGS for the FEED SHAFT and make sure the FEED SHAFT spins freely in the side frames.

Cleaning FEED ROLLER

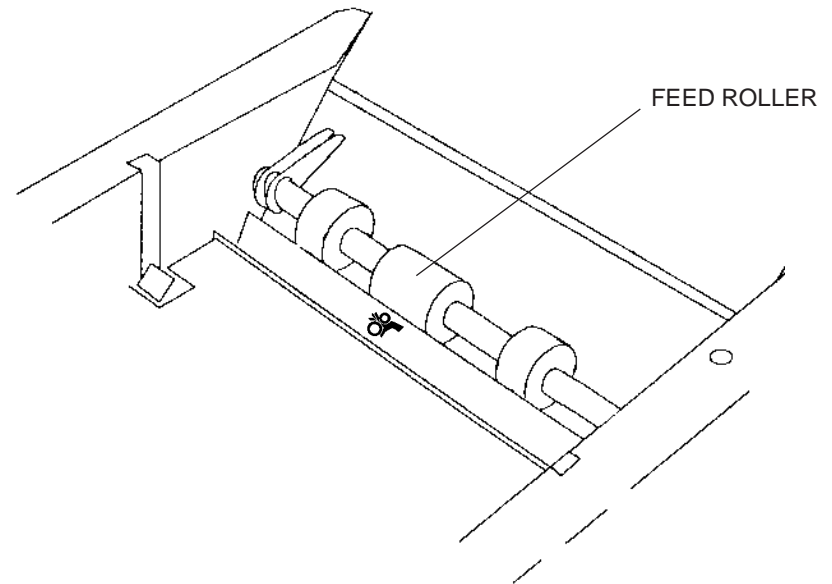

To clean FEED ROLLER:

1. Turn POWER SWITCH off.
2. Using a cloth and alcohol, clean entire FEED ROLLER.
3. Allow FEED ROLLER to dry completely before folding.

Adjusting SEPARATOR

The SEPARATOR must be set to feed one sheet of paper at a time.

WARNING: Turn POWER SWITCH off and unplug POWER CORD before making adjustment.

To adjust SEPARATOR:

1. Clean FEED ROLLER before adjusting SEPARATOR. (Refer to page 9.)
2. Fold a strip of standard (20# bond) paper in half. Hold HOPPER door open. Turning the FEED ROLLER by hand, feed the sheet under the roller.
3. Hold the FEED ROLLER so it cannot turn. Pull the strip out. It should pull out with some difficulty.

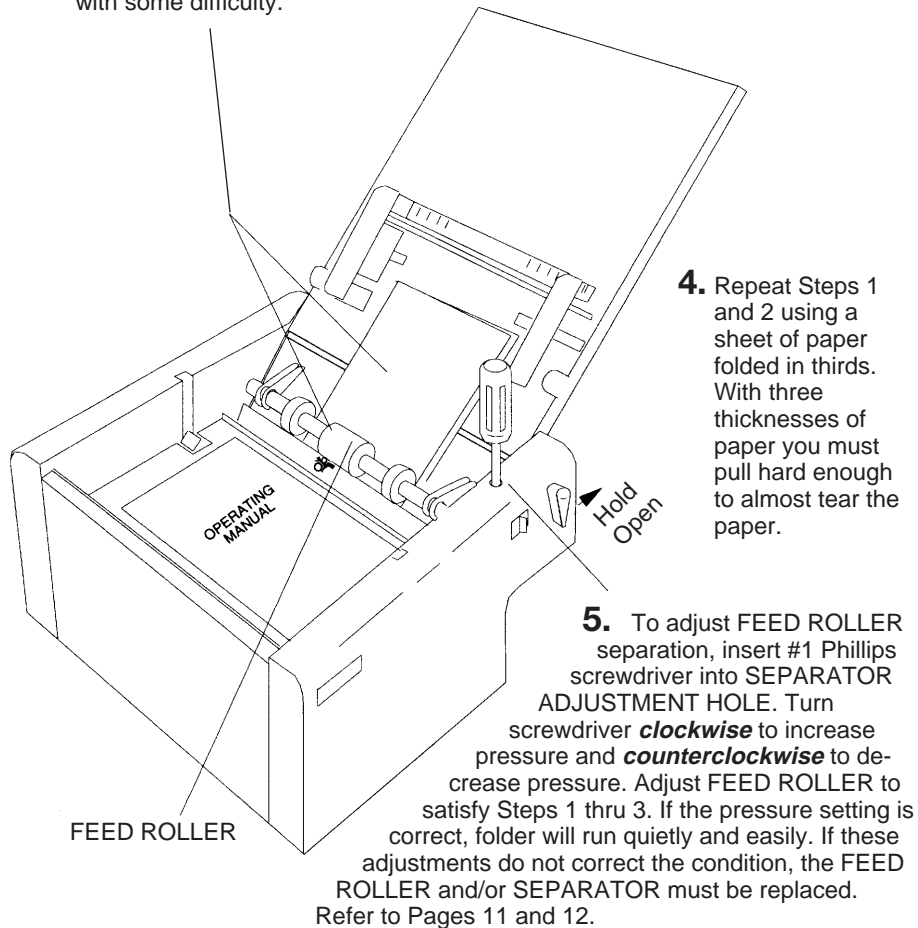

Replacing SEPARATOR

The SEPARATOR (located below the FEED ROLLER) is a **very important** part of the automatic feeding system. Keeping the SEPARATOR adjusted as it wears (see Page 10) will insure proper operation. If the adjustment screws run out of travel and can no longer be adjusted, the SEPARATOR HOLDER ASSEMBLY (part # 7F1596) must be replaced. It is also recommended that the FEED ROLLER (part # 3F1525) and CLUTCH SPRING (part # 3F1581) be replaced.

To change the SEPARATOR:

1. Turn POWER SWITCH off and unplug POWER CORD.
2. Remove both SIDE COVERS. **NOTE:** *The fold dials must be removed.* Observe the alignment of dials and tightness of ACORN NUT for dial tension. Remember to reconnect the POWER SWITCH.
3. Remove the PAPER DEFLECTOR (with static brush attached) at the output end of folder by removing the screws in the side frame.
4. Remove the plastic FEED SHAFT PULLEY on the non-operator side and remove the square SHAFT HOLDER on both sides as well as the SEPARATOR ADJUSTING SCREW and SPRING.
5. Remove the loose SEPARATOR SQUARE SHAFT ASSEMBLY through the output end of the folder. Turn the shaft so the pin on the non-operator side clears the keyhole.
6. Install the new SEPARATOR SHAFT ASSEMBLY the same way old assembly was removed.
7. Assemble the SQUARE SHAFT HOLDER on non-operator side first. **NOTE:** *Make sure the SEPARATOR PATCH is positioned to fit through the hole under the FEED ROLLER. The SQUARE SHAFT should slide through the slots with little or no interference.*
8. Re-assemble SEPARATOR ADJUSTMENT ASSEMBLY and re-adjust the SEPARATOR using instructions on Page 10.